



**Owner's Manual**  
**Model: MTS-T4-LGN**





## **Congratulations on your purchase of the RigMaster Auxiliary Power Unit!**

RigMaster is a totally self-contained, stand-alone generator, Air Conditioner and Heater System. The only items that are shared with your Truck Systems are fuel and battery supply. The RigMaster unit also trickle charges the Truck batteries while in operation.

Superior design and performance have been incorporated into this product to give you trouble-free, economical operation. We are confident you will be satisfied with your new RigMaster Auxiliary Power Unit.

The following pages contain design features, principles of operation, preventative maintenance procedures and troubleshooting guides. Please review it carefully prior to starting and operating your RigMaster Unit. For safety's sake, please also heed all safety warnings and advisories found within your Owner's Manual.

Should you have any questions or concerns please contact your nearest authorized RigMaster Power Dealer, or RigMaster Power International Ltd. at:

**1-888-208-3101**

**(For technical support only)**

### **HAVE YOUR SERIAL NUMBERS READY WHEN YOU CALL**

**To find APU Serial Number:** Remove the APU Cover and look for S/N Plate on bottom right-hand corner of frame.

**Write down your Serial Numbers for future reference:**

Engine S/N: \_\_\_\_\_

APU S/N: \_\_\_\_\_

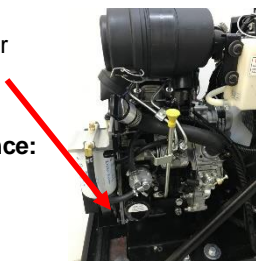

## Definitions

**NOTE**

A NOTE describes important information necessary to properly complete a procedure, or information which will make the procedure easier to understand.

**CAUTION**

A CAUTION describes a special procedure or special steps which must be taken while completing a task. Disregarding a CAUTION may result in damage to the assembly.

**WARNING!**

A WARNING describes a special procedure or steps, which must be taken while completing the procedure where the warning is found. Disregarding a WARNING can result in serious personal injury or death.

## **Additional Publications**

“Model LGN APU Service Manual”

“Model LGN APU Installation Manual”

See your Honda Dealer for these other publications:

Honda Engines- Dry Gas V Twin Engines OEM Technical Manual

Honda Engines-GX630\_690\_Dualfuel

Honda Engines-14043667571\_Honda\_GX630-660-690-workshop\_manual

Licensed dealerships may review and download additional publications by logging into their Dealer portal.

### **NOTE**

Owner's Manuals and APU Parts Lists are publicly accessible and downloadable:

go to [www.rigmasterpower.com](http://www.rigmasterpower.com)

hold your cursor over the “customer support tab” and select “support materials”

On this web page, also note “PARTS LISTS - ALL MODELS AS OF (DATE)” —this lists all parts ever used in our APU's. All parts are available to order.

This Manual is divided into sections by engine and assembly systems, with a section dedicated to the preventative maintenance of the APU. For detailed information on installation please refer to the “model LGN APU Installation Manual”. For detailed information on engine service please refer to either the Honda Service Manual.

Read this entire Manual prior to performing service and maintenance procedures. If you do not fully understand how to perform a process or procedure or require additional help, please contact our Technical Support Department before proceeding.

## **Technical Assistance**

Before calling for technical assistance please have ready the following:

1. Current LGN Service Manual
2. Model LGN Serial Number
3. Unit Hour Meter Reading
4. Service & Repair History (if available)

**Technical support is available by**

**Telephone: (888) 208-3101 or (416) 201-0040**

**Monday to Friday from 8:00 a.m. to 5:00 p.m. Eastern Standard Time  
and**

**Website: [www.rigmasterpower.com](http://www.rigmasterpower.com)**

**(click: Customer Support, Support Materials, Technical Support)**

**Table of Contents**

<b>Principles of Operation</b>	<b>Page #</b>
Preface – Additional Publications/Technical Assistance	1
Safety	5
Heater	8
Air Conditioner	9
Pre-Start Inspection	11
Cabin Controller Description and Operating Instructions	12
Clock and Date Set-Up	18
Set Alarm Clock	19
AutoStart Features	20
FAULT CODES	22
Fuel System Description and Bleeding Procedures	27
Preventative Maintenance Schedule	29
Cross Reference Parts List	30
<b>Normal Maintenance &amp; Adjustment Instructions</b>	
Oil Change Instructions	31
Air Filter Change Instructions	34
Serpentine Drive Belt – Removal	35
Cleaning Instructions	37
Cleaning – HVAC Filter	38
Troubleshooting	39
<b>Warranty</b>	
RigMaster APU Limited Warranty	44
Maintenance Record	50
Notes	51

## Zero Energy State

### NOTE: ZERO ENERGY STATE

To perform service, maintenance and repairs you must disconnect the RigMaster from its battery source. In the recommended installation configuration, the RigMaster shares the battery bank with the vehicle's main engine. Unplug the J1 harness at the power module before disconnecting the battery cables. After disconnecting the battery cables, check the battery posts inside the RigMaster engine cabinet to confirm there is no voltage to the auxiliary power unit (APU).

## 1. Safety Cover Switch

### WARNING! SAFETY COVER SWITCH

It is critical that this safety cover switch is never bypassed; failure to comply may result in serious injury.

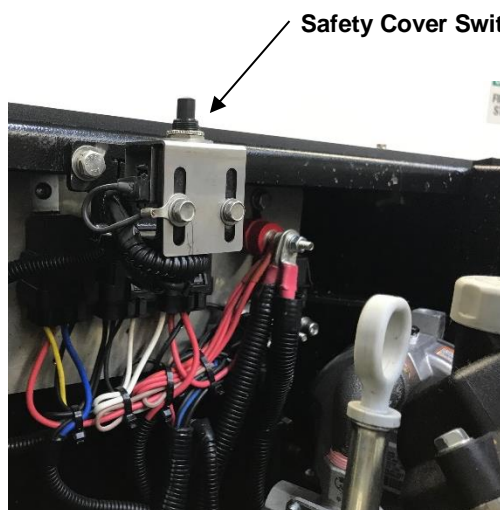

The safety cover switch (Figure 1) is designed to prevent the RigMaster Power APU from starting when the engine cover is loose or has been removed. When the cover is down, the switch is in the closed position. When the cover is open or loose, the switch is in the open position. The switch is located at the very top of the unit enclosure near to main wire harness plate.

Figure 1 – Safety Cover Switch

## 2. AutoStart Automatic Start/Stop Feature

### CAUTION: AUTOSTART FEATURE

Remember that a properly functioning RigMaster is capable of starting independently of its operator. If the AutoStart feature is enabled, battery voltage, temperature, and time of day can all cause the RigMaster' engine to start. Please see the cabin controllers operating instructions for further information on the AutoStart feature.

**You must deactivate this feature prior to refueling.**

## 3. Engine Hoist Points

### NOTE: ENGINE HOIST POINTS

The Honda engines have hoist points that are useful for removal and reinstallation of the engine. It is advised that these hoist points should only be used if no other means of lifting the unit are available.

## 4. Starting Aids

### WARNING!

Do not use any type of starting aids such as ether. Such use could result in an explosion and personal injury and will render the APU warranty null and void.

## 5. Starting with the Cover Off

### CAUTION

Some installation or repair/diagnostic procedures require that the APU is started with the engine cover off. Do not deactivate or bypass the safety cover switch. Instead, have another individual assist by manually holding the safety cover switch down in the closed position for the duration of the procedure.

## **6. Inspection of the Safety Systems**

The safety systems on the RigMaster APU should be examined and tested at prior to performing any service work and at 50-hour intervals to ensure that they are in good condition and proper working order.

## **7. Safe Working Practices**

Safe working practices are your responsibility. The use of protective safety equipment is mandatory when performing inspections, service, diagnostics and repairs on the RigMaster APU. Follow your local regulations and guidelines regarding occupational health and safety.

## **8. Contact Us**

If you do not fully understand this safety information, contact RigMaster's Technical Support Department toll free at (888) 208 – 3101 before proceeding with the operation or service of this APU.

**Heater: (only applicable if unit has automotive style heating)**

The RigMaster heating system is fully automatic. A constant comfort zone is maintained with the temperature selector (see Cabin Controller Operation – Page 11). The bunk heating system is a complete stand-alone system that is not integrated into the vehicle's cooling system. When heat is selected, and the RigMaster is in operation, the hot coolant flows through the heater core (installed under the bunk – see Figure 2).

The heater/air conditioner blower motor (fan) circulates the cab air through the heater core pushing warm air into the bunk area. The coolant is then re-circulated back to the RigMaster Unit.

This system is designed to maximize the bunk heating efficiency.

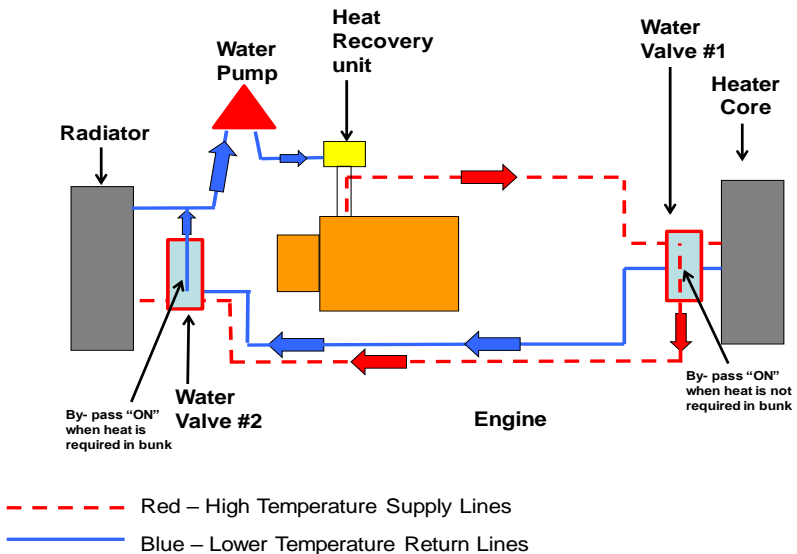

**Figure 2 – Heater**

## Air Conditioner

The RigMaster air conditioner is also fully automatic. A constant comfort zone is maintained with the temperature selector setting (see Cabin Controller Operation – Page 11). The RigMaster air conditioner is an R134A system that is not integrated into the vehicle's existing air conditioning system.

### WARNING!

ONLY CERTIFIED AIR CONDITIONING TECHNICIANS SHOULD SERVICE THE AIR CONDITIONER.

### HIGH PRESSURE VS. TEMPERATURE READINGS

High temperatures and pressures are approximate.

Readings within 10-15% of Figure 3 will deliver acceptable performance.

### Air Conditioning Performance

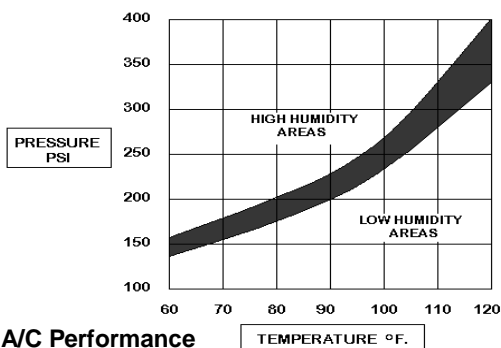

Figure 3 – A/C Performance

### SUCTION PRESSURES – LOW SIDE

Usual low side pressure 15-40 PSI depending on outside temperature and humidity.

### DISCHARGE PRESSURES – HIGH SIDE

Usual high side pressure 150-300+ PSI depending on outside temperature and humidity.

AIR CONDITIONING	SPECIFICATIONS
Refrigerant Type	R134a
Volume of Refrigerant - Single Blower (20,000 BTU)	0.65 lbs.; (10.4 oz.; 0.29 Kg.)
Volume of Refrigerant - Dual Blower (24,000 BTU HVAC)	1.0 lb.; (16 oz.; 0.4 Kg.)
Compressor Oil Type	SP46 PAG Compressor Oil
Compressor Oil Capacity (already filled with 3.3 oz.; <b>add an extra 3 oz. at time of charging</b> )	6.3 fl. oz.; (186.3 cc.; 186.3 mL.)
Evaporator Temperature Switch	Range = 30°F to 42°F (-1°C to 7°C)
Binary Pressure Switch	Range = 28 to 450 psi

The compressor within the RigMaster unit pumps the refrigerant gas through the condenser that dissipates the heat and changes the refrigerant from a gas to a liquid. The liquid refrigerant passes through a filter (receiver dryer), and then through the evaporator core located in the bunk heater/air conditioner unit. The heater/air conditioner blower motor (fan) then activates, and cool dry air is forced into the bunk area.

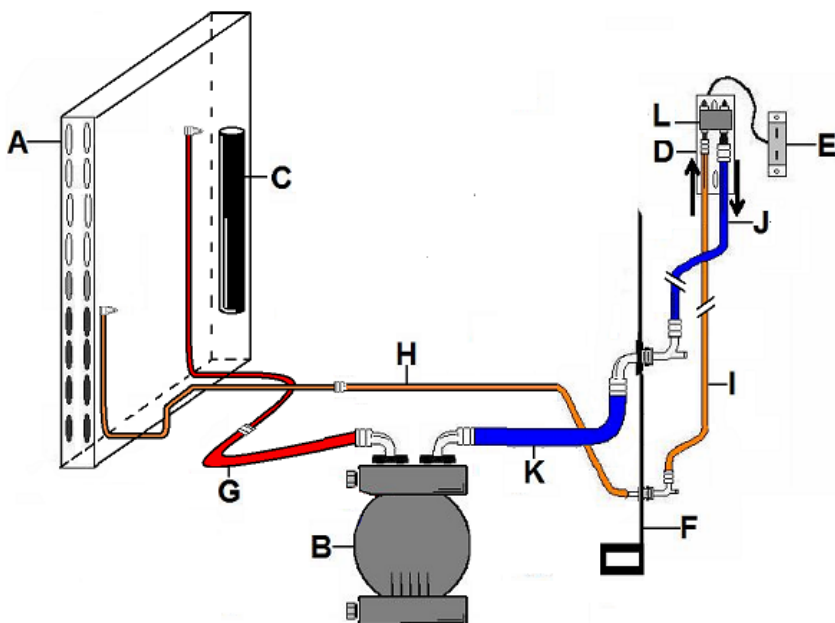

Figure 4 – Air Conditioner

LEGEND		PRESSURE	PART #
A	Condenser	High	LG9-001
B	Compressor	High/Low	LG9-004
C	Receiver Drier	High	LG9-007
D	Evaporator	High	LG9-002-
E	Thermostatic Switch	High/Low	RP9-113
F	Bulkhead Section of Frame	N/A	LG10-001
G	A/C Line – Compressor to Condenser – #8	High	LG9-400
H	A/C Line – Condenser to Bulkhead – #6	High	LG9-402
I	A/C Line – Bulkhead to Evaporator	High	LG9-404
J	A/C Line – Evaporator to Bulkhead	Low	LG9-403
K	A/C Line – Bulkhead to Compressor - #10	Low	LG9-401
L	Expansion Valve	High/Low	LG9-003

## **Pre-Start Inspection**

### **with the RigMaster TURNED OFF**

1. Remove the cover.
2. Visually inspect the unit for evidence of oil or coolant leakage.
3. Check the oil and add oil if necessary.
4. Check the tension and wear of all belts.
5. Check the mounting bolts and tighten if necessary.
6. Check for broken, corroded, or loose connectors and/or wires.
7. Check the physical condition and tightness of all hoses and hose clamps.
8. Replace and secure the cover.

## Cabin Controller Operating Instructions

Before beginning the start-up procedure, it is necessary to know how to operate the cabin controller.



**Figure 5 – Cabin Controller**

### Controls

The Cabin Controller consists of two sections:

1. LCD (Liquid Crystal Display) with basic control buttons.
2. Advanced control buttons.

The LCD and basic control buttons are always visible to the user. The advanced control buttons are concealed behind semi-circular cover.

The controller also contains a LED indicator. When the LED is green, the system is active; if it glows red then the system is detecting a problem and an error message will scroll across the bottom of the LCD screen. The LED is turned off in low power mode.

### 1. Basic Controls and Functions

Basic controls contain the following buttons:

1. Start system.
2. Stop system.
3. Up arrow (Red triangular button).
4. Down arrow (Blue triangular button).

If the unit is in *advanced* mode, pressing any of the basic control buttons will return the unit to basic mode. Alternately, the control panel will return to basic mode after two minutes of inactivity.

If the unit shows the current temperature, pressing either the up or down button will show the set point temperature without changing it. Once the set point is indicated, pressing up or down buttons will adjust the set point. The new set point takes effect only when display is returned to show internal temperature.

## 2. Advanced Controls and Functions

The advanced controls are as follows:

1. **Power** button controls whether the module is active. In *inactive* mode all system functions including engine start, climate control and AutoStart are disabled. You can still see the temperature reading, current time and use the alarm clock function.
2. **Fan** button is used to change fan setting. Pressing the button cycles between auto, high, med, low, and off settings.
3. **Clear** button will take you back to the main screen without saving any information.
4. **Clock** button is used to set the time/date/day menu features.
5. **Alarm** button is used to set the alarm menu features.
6. **AutoStart** button is used to access and set AutoStart menu features.
7. **Mode** button is used to activate the different operational modes. Pressing the mode button will back you out of a menu mode but does not save the information just entered.
8. **Ext. Temp** button will display the external temperature on the LCD when pressed.
9. **Opertg. Hours** button will display the total hours of use.
10. **Select** button enters the data and advances the program to the next menu step. Pressing the select button will save the information when entering operational data.
11. Left scroll button (◀).
12. Right scroll button (▶).

The left and right arrow buttons are used to locate the desired data and/or adjust those values.

## Cabin Controller LCD Display

The Cabin Controller LCD has a white backlight that turns on each time a user presses a button and will remain on for 2 minutes after the last button has been pushed. The backlight will turn red when there is an alarm condition. A fault code will be displayed if the unit shuts down or fails to start.

The LCD displays 4 groups of information:

1. System information.
2. Temperature information.
3. Clock, day and alarm information.
4. Alphanumeric display for additional information.

### 1. System Information:

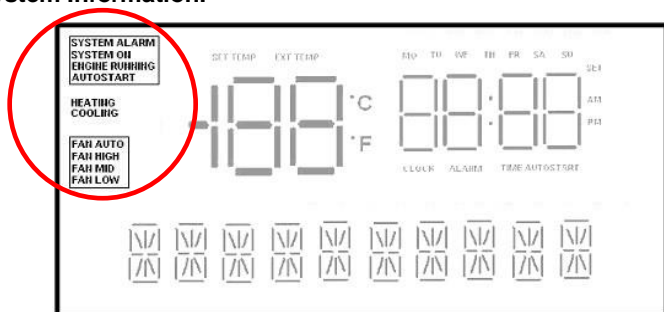

**Figure 6 – Cabin Controller LCD Display – Controls**

**SYSTEM ALARM** symbol will flash if an alarm condition has occurred. The alphanumeric display along the bottom of the display screen will show more information about the alarm. (Red status LED will be on.)

**SYSTEM ON** symbol will display if the unit is in ON mode. (Green status LED will be on.)

**ENGINE RUNNING** symbol will display when the engine is running.

**AUTOSTART** symbol will display and flash if temperature AutoStart is enabled (when engine is off). If the engine has been started through AutoStart, this symbol is constantly on while the engine is running.

**HEATING** symbol will display when the system is in heating mode.

**COOLING** symbol will display when the system is in cooling mode.

**FAN AUTO, FAN HIGH, FAN MED, or FAN LOW** symbol will display depending on which setting has been selected. Nothing will display in this area if the fan is set to off.

## 2. Temperature Information:

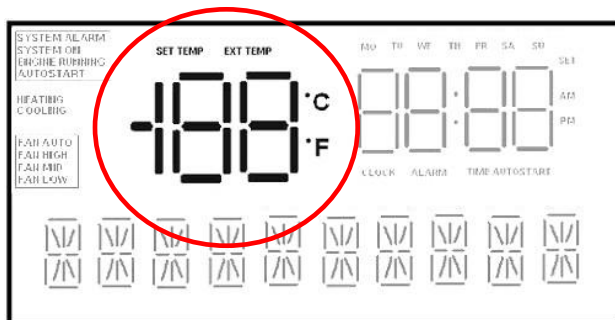

**Figure 7 – Cabin Controller LCD Display – Temperature**

This area indicates the internal (or external) temperature and can be programmed to display in either “Celsius” or “Fahrenheit”.

Internal temperature is shown if **EXT TEMP** and **SET TEMP** symbols are not illuminated. Pressing the **Ext. Temp** button will momentarily display the outside temperature. After 5 seconds, the display will default back to showing the internal temperature.

**EXT TEMP** symbol will flash when showing external temperature. After a few seconds the display returns to show internal temperature.

**SET TEMP** symbol appears (and the numeric temperature value will flash) whenever adjusting temperature set point. A few seconds after adjusting the temperature, the display returns to show internal temperature.

### 3. Clock and Alarm:

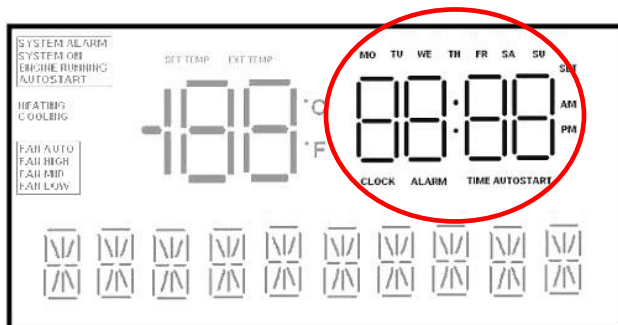

**Figure 8 – Cabin Controller LCD Display – Clock & Alarm**

This is a 12:00 hour clock system with **AM/PM** symbols and 7 symbols indicating day of the week: **MO, TU, WE, TH, FR, SA, SU**.

**CLOCK** symbol appears when the current time is showing.

**ALARM** symbol appears to indicate that the alarm setting is showing. Pressing the alarm button allows you to set the alarm. The alarm symbol flashes when the alarm has been set.

**TIME AUTOSTART** symbol appears if the display shows time AutoStart setting. It flashes if Time AutoStart is set.

### 4. Additional Information/Message Area:

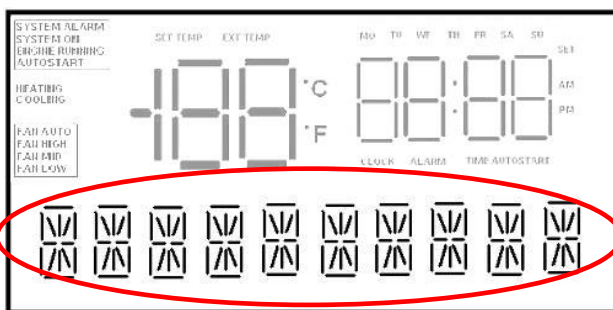

**Figure 9 – Cabin Controller LCD Display – Message Area**

This line is used to show extra information in the basic mode; error messages to provide interface when going through menus in advanced mode. Longer text lines are scrolled to the left on the display.

## Operation of the Cabin Controller (Functions)

### To Turn Power On

Press the **POWER** button to activate the system. When the power switch is activated the LCD display will light and **SYSTEM ON** symbol will turn on (active mode). Press **POWER** button again for 2 seconds to switch the unit back to low power mode.

### Engine Start

Press **START** button.

The control panel will display the status of the operation as it occurs: *Glow Plug* and a countdown will display on the screen. Once the countdown is complete the display will read *Cranking* as the APU starts up and the **ENGINE RUNNING** symbol will blink. Once started the control will display *Engine Running* for 5 seconds (and **ENGINE RUNNING** symbol will turn on).

### Engine Stop

Press **STOP** button.

The screen will initially display *Stopping* and then change to *Stopped* once the operation is complete. The **Engine Running** symbol will turn off.

### Temperature Control

Press UP or DOWN (red/blue) buttons to adjust temperature set point on the display. When editing the set point, the LCD display will show the set point instead of internal cabin temperature. The set point is stored without a need to press any other buttons.

#### NOTE

The manual temperature control ranges from 59°F to 90°F (15°C to 32°C). The system will remember the last set temperature when the APU is turned on. If the system is already running, the change will take effect a few seconds after the last UP or DOWN key is pressed, and the display will switch back from set point to internal cabin temperature.

### Clock and Date Set-Up

It is necessary to enter the time and date programming mode if the module has never been programmed or a different time zone is required. (**SET** symbol is flashing, and **CLOCK** symbol is turned on during clock setup).

1. Press **CLOCK** button. (The display will read *Set Clock*.)
2. Press **SELECT** button to continue, **MODE** to exit. (*Clock hour* will start flashing.)
3. Press LEFT or RIGHT scroll button to adjust Clock hour.
4. Press **SELECT** button. (*Clock hour* will stop flashing and *Clock minutes* will start flashing.)
5. Press LEFT or RIGHT scroll button to adjust *Clock minutes*.
6. Press **SELECT** button. (*Clock minutes* will stop flashing and *AM/PM* will start flashing.)
7. Press LEFT or RIGHT scroll button to change.
8. Press **SELECT** button. (*AM/PM* will stop flashing and *Day of week* will start flashing.)
9. Press LEFT or RIGHT scroll button to change.
10. Press **SELECT** button. (*Day of week* will stop flashing and *Month* will start flashing.)
11. Press LEFT or RIGHT scroll button to change.
12. Press **SELECT** button. (*Month* will stop flashing and *Date* will start flashing.)
13. Press LEFT or RIGHT scroll button to change.
14. Press **SELECT** button to save settings and return to menu or press **MODE** to return to menu without saving.

### Set Alarm Clock

1. Press **ALARM** button. (The display will read *Set Alarm*.)
2. Press **SELECT** button to continue, **MODE** to exit. (*Alarm Clock hour* will start flashing.)
3. Press LEFT or RIGHT scroll button to adjust Alarm Clock hour.
4. Press **SELECT** button. (*Alarm Clock hour* will stop flashing and *Alarm Clock minutes* will start flashing.)
5. Press LEFT or RIGHT scroll button to adjust *Alarm Clock minutes*.
6. Press **SELECT** button. (*Alarm Clock minutes* will stop flashing and *AM/PM* will start flashing.)
7. Press LEFT or RIGHT scroll button to change.
8. Press **SELECT** button.
9. Press LEFT or RIGHT scroll button to turn Alarm clock on/off.
10. Press **SELECT** button to save settings and return to menu or press **MODE** to return to menu without saving.

When enabled, **ALARM** symbol is flashing.

### Fan Speed Control

1. Press **FAN** button to adjust fan speed.
2. Press the **FAN** button to cycle through fan settings. (*AUTO OFF, AUTO ON, FAN LOW, FAN MEDIUM, FAN HIGH, FAN OFF*.)

There is no need to press any other buttons to confirm.

AUTO OFF is for heating efficiency during winter operation.

AUTO ON is for air conditioning efficiency during summer operation.

#### NOTE

The air conditioning/heating system will only operate when the fan speed is in a setting other than *OFF*. To stop the operation of the air conditioning/heating system, the fan speed must be set to *OFF*. If the system was stopped by another method, the air conditioning/heating will start immediately when the system is restarted.

## AutoStart Features and Operation

### AutoStart Feature – Time/Day

Allows you to program a day and time for the APU to start automatically, up to 7 days in advance. This feature will run for three hours and shut down. At the end of the AutoStart program the cabin controller will display the error code #10, "Run Timeout"; this is normal.

### Set Automatic Start-Up/Shut-Down – Time/Day

The user can adjust the time and day for the next timed AutoStart event. (*SET* symbol is flashing, and *TIME AUTOSTART* symbol is turned on during alarm setup).

1. Press **AUTOSTART** button. (*Time AutoStart* will scroll across the screen.)
2. Press **SELECT** button to continue, **MODE** to exit.
3. Press LEFT or RIGHT scroll button to adjust *AutoStart hour* as required.
4. Press **SELECT** button.
5. Continue to set the *AutoStart Minutes* and *AM/PM* as you would set the clock. (See Section: *Clock and Date Set-Up*).
6. Press **SELECT** button after each entry.
7. Press LEFT or RIGHT scroll button to adjust *AutoStart Day* as required.
8. Press **SELECT** button.
9. Press LEFT or RIGHT scroll button to locate *On/Off*.
10. Press **SELECT** button to save settings or press **MODE** button to return to menu without saving.

**NOTE:** When enabled, **Time AutoStart** symbol will be flashing.

### AutoStart Feature – Temperature

Allows you to program a comfortable temperature setting; the APU regulates the temperature giving you further fuel savings on extended absences from the cab.

### Set Automatic Start-Up/Shut-Down – Temperature

1. Press **AUTOSTART** button twice. (*Temp AutoStart* will scroll across the screen.)

2. Press **SELECT** button to continue, **MODE** to exit.
3. Press LEFT or RIGHT scroll button to select mode of temperature control. (Mode options include *OFF*, *AUTO*, *HEAT* or *COOL only*.)
4. Press **SELECT** button to continue, **MODE** to exit.
5. Press LEFT or RIGHT scroll button to select AutoStart temperature set-point if *HEAT* or *COOL* have been selected.
6. Press **SELECT** button to save settings or press **MODE** to return to menu without saving.

**NOTE**

The Automatic Start temperature range is between 32°F and 95°F (0°C and 77°C).

When enabled, the **AutoStart** symbol will flash.

AutoStart temperature start-up will engage when the inside temperature is more than 5°F (3°C) lower or more than 5°F (3°C) higher than the temperature control setting (in auto mode). It also engages at least 1 minute after enabling AutoStart temperature.

**AutoStart Feature – Low Battery**

Automatically starts up the APU to charge the truck battery if it gets low. This option is always enabled in active mode. The voltage sensitivity of the low battery AutoStart feature can be adjusted; however, this is a Dealer programmable feature and must be performed at a RigMaster trained facility.

**Set Automatic Start-Up – Low Battery**

Low Battery AutoStart does not require that it be set by the user in the same way as the time/date and temperature based AutoStart features. All that is necessary to ensure that low battery AutoStart functions is to leave the APU engine OFF and the cabin controller powered on (active mode). However, the battery voltage that the AutoStart engages at can be reset by a Dealer technician. The default voltage is 12V +/- 0.2V.

**Version Display**

1. Press **MODE** button.
2. Current version of the Power Module software will appear on the screen.
3. Press **MODE** or **SELECT** to return.

## FAULT CODES

The LGN's electronic control will display fault codes on the LCD display if the unit fails to start or shuts down. The following table contains fault codes and information on the cause and/or remedy. These fault codes will display one time only; if the code is cleared from the cabin controller, failure will have to reoccur for the code to be displayed again.

CODE	REMEDY/CAUSE	REMEDY/COMMENT
<b>Error Code 1</b>  <b>Safety Cover Open</b>	Engine cover of APU unit is open. APU will not start or run until the cover is closed.	<ul style="list-style-type: none"> <li>• Cover not seated.</li> <li>• Damaged wiring.</li> <li>• Failed cover switch.</li> <li>• Switch out of adjustment.</li> </ul>
<b>Error Code 2</b>  <b>Low Engine Pressure/Air Filter Replacement</b>	Low oil pressure or air filter is blocked.	<ul style="list-style-type: none"> <li>• Low oil level.</li> <li>• Wiring damaged.</li> <li>• Faulty switch.</li> <li>• Dirty air filter.</li> </ul>
<b>Error Code 3</b>  <b>Battery Low Voltage</b>	Low battery voltage. Start system immediately to charge batteries.	<ul style="list-style-type: none"> <li>• Damaged or broken battery cables; failed battery.</li> <li>• Excessive load on batteries.</li> <li>• Faulty charging system.</li> </ul>
<b>Error Code 4</b>  <b>Engine Run Failure</b>	Engine may have started but didn't run properly. "AutoStart" is disengaged; attempt manual starting with START button.	<ul style="list-style-type: none"> <li>• Speed sensor adjustment (set air gap at 0.015").</li> <li>• Damaged speed sensor wiring.</li> <li>• Failed speed sensor.</li> </ul>
<b>Error Code 5</b>  <b>Low Coolant/Engine Overheated</b>	Engine will not run until temperature becomes normal or coolant level is at full in surge tank.	<ul style="list-style-type: none"> <li>• Low coolant or failed coolant level switch.</li> <li>• High engine temperature or failed engine temperature sensor (top of water pump, has single wire).</li> <li>• Damaged wire providing ground.</li> </ul>
<b>Error Code 6</b>  <b>Module Failure</b>	Power Module is not responding.	<ul style="list-style-type: none"> <li>• Failed power module.</li> </ul>

CODE	REMEDY/CAUSE	REMEDY/COMMENT
<b>Error Code 7</b>  <b>Engine Start Failure</b>	Engine did not start. "AutoStart" is disabled until operator presses <i>Select</i> button.	<ul style="list-style-type: none"> <li>• Bad glow plugs or relay.</li> <li>• Bad starter relay.</li> <li>• Failed glow plug.</li> <li>• Possible speed sensor issue.</li> </ul>
<b>Error Code 8</b>  <b>No Communication Error</b>	No communication between control panel and power module. Re-establish communication.	<ul style="list-style-type: none"> <li>• "Cat5e" communication cable possibly damaged (commonly available).</li> <li>• Poor connection at terminal; try plugging in a few times.</li> </ul>
<b>Error Code 9</b>  <b>Main Engine Running</b>	APU will not run if the Truck's main engine is already running. This feature is "optional".	<ul style="list-style-type: none"> <li>• If a "switched 12-volt DC wire" is connected to the J4, Pin #4 (red) wire at the power module, the APU will not run. This is "optional".</li> </ul>
<b>Error Code 10</b>  <b>Run Timeout</b>	APU shuts down at three (3) hours of running when the "AutoStart" Time/Day Setting is used.	<ul style="list-style-type: none"> <li>• Engine will only run for three (3) hours when set on AutoStart Time/Day.</li> </ul>
<b>Error Code 11</b>  <b>Check Power Module Fuse</b>	Very low battery voltage detected at the power module.	<ul style="list-style-type: none"> <li>• Check 20 Amp. fuse and J1 connector at the power module (located under the bunk on the HVAC unit).</li> </ul>
<b>Error Code 12</b>  <b>Battery Charging Failure</b>	Battery voltage still low two (2) minutes after cranking. Auto and manual starts can occur.	<ul style="list-style-type: none"> <li>• Faulty charging system; failed batteries; poor connection.</li> <li>• Engine harness ground wires disconnected at the HVAC unit.</li> </ul>
<b>Error Code 13</b>  <b>Battery Discharge</b>	Alarm system will enter low power mode. No starting options given.	<ul style="list-style-type: none"> <li>• Failed batteries or connection.</li> <li>• Possible poor connection at power module.</li> </ul>

CODE	REMEDY/CAUSE	REMEDY/COMMENT
<b>Error Code 14</b>  <b>Check External Temperature Sensor</b>	External temperature sensor may not be connected to the power module.	<ul style="list-style-type: none"> <li>External temperature sensor disconnected or failed.</li> <li>Connection loose or damaged.</li> </ul>
<b>Error Code 15</b>  <b>External Temp Disable Limit</b>	Engine shut down due to external temperature outside the programmed range.	<ul style="list-style-type: none"> <li>The APU has been programmed not to start when the external temperature is outside a preprogrammed range.</li> </ul>
<b>Error Code 16</b>  <b>Module Reset – Set Clock</b>	Power to the cabin controller has been lost.	<ul style="list-style-type: none"> <li>Reset clock.</li> </ul>
<b>Error Code 17</b>  <b>Low Oil Level</b>	Oil level is low Adjust oil level	<ul style="list-style-type: none"> <li>Check and adjust oil level as needed.</li> <li>Check for broken signal or ground wire</li> <li>If wires are OK, replace sensor</li> </ul>
<b>Error Code 18</b>  <b>Replace Exhaust Filter (for unit equipped with Diesel Particulate Filters)</b>	Replace exhaust filter if unit is DPF equipped; if not DPF equipped, then power module failure likely.	<ul style="list-style-type: none"> <li>See authorized Dealer for exhaust filter replacement or power module diagnosis/replacement.</li> </ul>
<b>Error Code 19</b>  <b>Please Register Unit</b>	Unit will run for four (4) hours after installation. Registration code must be entered into the cabin controller display keypad.	<ul style="list-style-type: none"> <li>To obtain registration code, please call the APU Manufacturer (1-800-249-6222) with the serial # of your unit. There is no charge for this service.</li> </ul>

CODE	REMEDY/CAUSE	REMEDY/COMMENT
<b>Error Code 20</b>  <b>Water Valve Overcurrent</b>	Electronic coolant control valve drawing excess amperage.	<ul style="list-style-type: none"> <li>Unplug J2 connector, turn POWER ON again. Code should not display when J2 is unplugged.</li> </ul>
<b>Error Code 21</b>  <b>GP Overcurrent</b>	Glow plug relay drawing excess amperage.	<ul style="list-style-type: none"> <li>Glow plug relay operation is faulty or wire broken.</li> </ul>
<b>Error Code 22</b>  <b>Run or GP Overcurrent</b>	Run solenoid or glow plug relay drawing excess amperage.	<ul style="list-style-type: none"> <li>Unplug run solenoid; power with jumper wire; attempt again. If code returns, glow plug relay problem.</li> </ul>
<b>Error Code 23</b>  <b>Run Overcurrent</b>	Run solenoid is drawing excess amperage.	<ul style="list-style-type: none"> <li>Unplug run solenoid; power with jumper wire; attempt again; measure Amps. If code returns, broken wire.</li> </ul>
<b>Error Code 24</b>  <b>Start or Run Overcurrent</b>	Starter relay or run solenoid drawing excess current.	<ul style="list-style-type: none"> <li>Unplug run solenoid; power with jumper wire; attempt again. If code returns, starter relay problem.</li> </ul>
<b>Error Code 25</b>  <b>AC or Run Overcurrent</b>	A/C clutch or run solenoid drawing excess current.	<ul style="list-style-type: none"> <li>Unplug run solenoid; power with jumper wire; attempt again. If code returns, A/C clutch problem.</li> </ul>
<b>Error Code 26</b>  <b>BH Overcurrent</b>	Phantom Code – block heater is not operated by power module output. (no output on J1 Pin #7).	<ul style="list-style-type: none"> <li>May indicate damage to power module circuit board. Possible solution: Unplug J1 connector for 30 seconds.</li> </ul>
<b>Error Code 27</b>  <b>Power down to clear overcurrent</b>	Power must be turned off with the power button then turned back on.	<ul style="list-style-type: none"> <li>This message appears if engine start is attempted without turning POWER OFF. Turn power OFF then ON.</li> </ul>

CODE	REMEDY/CAUSE	REMEDY/COMMENT
<b>Error Code 28</b>  <b>Output Overcurrent</b>	A power module output circuit sees a rise in amperage while trying to activate an electronic component. Output circuit shuts off to protect itself.	<ul style="list-style-type: none"><li>Similar to a circuit breaker function; caused by a stuck or failed relay, solenoid or servo. Power OFF with controller for a minute and function will return. Test each power module output circuit for amperage draw.</li></ul>

## Fuel System

### WARNING!

Do **not** use aerosol types of starting aids such as ether. Such use could result in an explosion and personal injury and will render the warranty null and void.

The fuel system consists of an IMPCO regulator and fuel lock-off. When

Regulator Assembly Specifications	
Working Fluids	Vapor phase liquid Petroleum gas (LPG), natural gas
Max. Working Pressure	3.43 kPaG (0.498 psig, 13.8" H <sub>2</sub> O)
Sustainable Pressure	29.4 kPaG (4.26 psig)
Electrical Rating	12 Vdc
Power Consumption	16W @ 20 °C
Ambient Temperature	-15 ~ 80 °C (5 ~ 176 °F)
Mounting Position	Vertical ± 5°
Vibration (durability)	10 G / 60 Hz x 200 hr continuous
Standards & Regulations	UL approved; CARB certified
Internal Leakage	With 3.43 kPaG applied to inlet: leakage at outlet <10 cc/hr
External Leakage	With 9.8 kPaG applied to inlet, solenoids open, and outlet plugged: no external leakage from assembly

## Fuel Supply

### WARNING!

Do not use Teflon tape on threaded joints. Particles of tape may become dislodged and clog metering orifices. Use only a pipe-joint compound

### Natural Gas

The regulator will accept natural gas at 7 to 11 in H<sub>2</sub>O. Use a first-stage regulator in the supply feed to reduce pressure. Connect the supplied low-pressure hose to the fitting on the T-joint marked "NG".



Fig 8-Natural Gas position

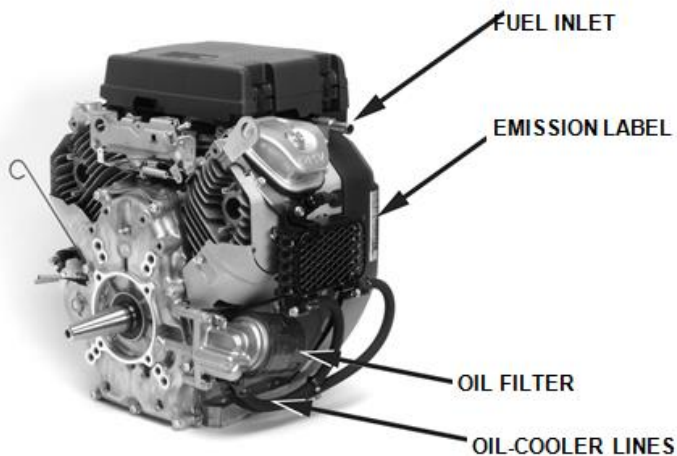

Figure 9 – Fuel System Components

#	DESCRIPTION
1	Fuel Inlet
2	Emission Label
3	Oil Filter
4	Oil Cooler Lines

## Preventative Maintenance

The first oil change must be performed at **50 hours** of service and at 500-hour intervals thereafter. Please read the following chart for detailed information. The maintenance schedules are for Normal road conditions and the specific hour intervals must be adhered to in order to maintain the manufacturers' warranties. For SEVERE conditions perform the scheduled maintenance sooner.

SCHEDULED INTERVALS IN HOURS				MAINTENANCE ITEMS
50	250	500	1000	
X				First Engine Oil Change.
X	X	X	X	Check APU for leaks/damage; repair if found.
	X			Inspect Fan Belt Condition/Adjustment.
	X			Inspect Serpentine Belt for wear.
X		X	X	Check all Fasteners for tightness.
		X		Valve Clearance Inspection. Intake and Exhaust valve clearance are both 0.0078".
		X	X	Vibration Mounts – pry up on the engine mount plates, there should be less than 1" of upward movement.
		X		Change Engine Oil and Filter.
			X	Check HVAC unit filter; clean if necessary.
		X	X	Clean engine compartment, condenser, and radiator. Use compressed air or liquid degreaser.
			X	Check engine air filter; change if necessary.
			X	Check serpentine belt; change if necessary.
	X			Check Spark plug gap (0.28-0.031")
			X	Change spark plug

### NOTE

The use of conditioner may extend the service life of belts; consult the belt manufacturer for more information on the maintenance belt.

**RigMaster Power Approved Cross-Reference Parts List****OIL FILTER**

<b><u>BRAND</u></b>	<b><u>PART No.</u></b>
RigMaster	TBD
Honda	15400-PLM-

**AIR FILTER**

<b><u>BRAND</u></b>	<b><u>PART No.</u></b>
RigMaster/ Donaldson	17210-Z6L-900

**SERPENTINE DRIVE BELT**

<b><u>BRAND</u></b>	<b><u>PART No.</u></b>
RigMaster	LGN8-000

**RECEIVER-DRIER ELEMENT**

<b><u>BRAND</u></b>	<b><u>PART No.</u></b>
RigMaster	LG9-007

**THE USE OF COMPONENTS NOT LISTED  
IN THIS TABLE MAY CAUSE DAMAGE TO  
THE ASSEMBLY AND VOID THE  
MANUFACTURERS' WARRANTY**

**Spark Plug**

<b><u>BRAND</u></b>	<b><u>PART No.</u></b>
RigMaster	IK16#4 (5303)

## Oil Change

OIL	S.A.E./(S.I.)
Volume	2 Liter / 2 US Quarts
Type	SG or SF
Viscosity	Variable:

### CAUTION

Consult a Honda Dealer about the use of synthetic oil in your RigMaster. Service intervals for oil and oil filter replacements are 500 hours. Synthetic oil is not suitable for use as break-in oil during the first 1000 engine operating hours.

### Oil Viscosity vs. Temperature

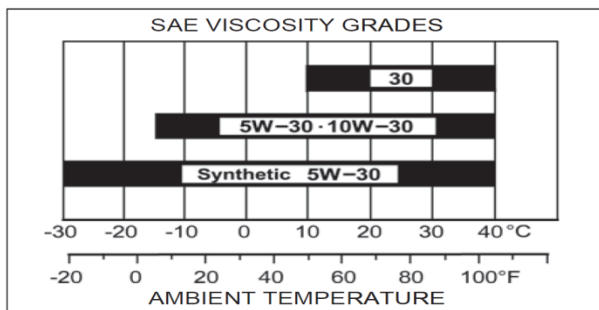

SAE 10W30 API  
service classification  
SG or SF

Figure 10 –Oil Viscosity vs. Temperature

## Replacing the Engine Oil and Oil Filter

### Checking Engine Oil Level

1. Start the engine and allow it to warm up for 1 to 2 minutes
2. Remove the oil level dipstick (1) and wipe it clean.
3. Insert the oil level dipstick into the oil level pipe (2).
4. Remove the oil level dipstick and check oil level shown on the tip of the level dipstick.
5. If the oil level is near or below the lower level mark (3) on the oil level dipstick, remove the oil filler cap (4) from the head cover and fill with recommended oil to the upper level mark (5) of the level dipstick.

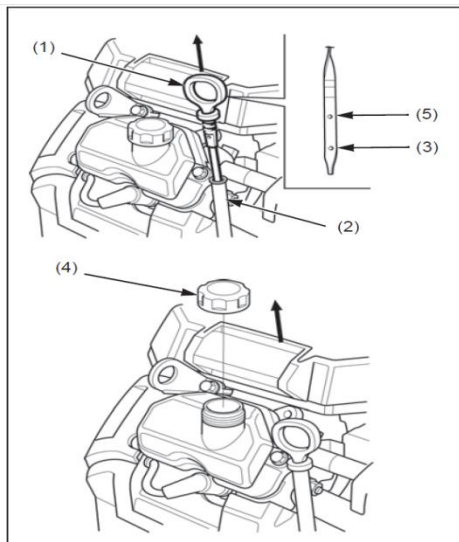

Figure 11- Oil Cap and Dip stick

### Changing Engine oil

1. Drain the oil in the engine while the engine is warm. Warm oil drains quickly and completely.
2. Place a suitable container under the drain plug bolt (1).
3. Remove the oil filler cap (2) from the head cover (3) and the drain plug bolt to drain the oil into a suitable container.
4. Please dispose of used motor oil in a manner that is compatible with the environment. We suggest you take used oil in a sealed container to your local recycling center or service station

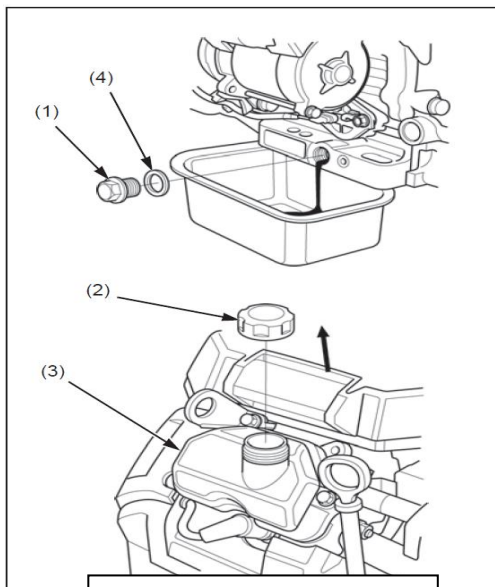

Figure 12- Oil pan and Oil Cap

5. for reclamation. Do not throw it in the trash, pour it into the ground, or down a drain.
6. Install a new drain plug washer (4) and tighten the drain plug bolt to the specified torque.
7. Fill with recommended oil to the upper level mark of the oil level dipstick.
8. Tighten the oil filler cap and install the oil level dipstick securely.

## Replacing Oil Filter

1. Drain the engine oil.  
Remove the oil filter (1) using filter wrench or use the Honda special tool (2).

### TOOLS:

#### Oil Filter Wrench (079211-6110001)

2. Apply a light coat of grease to the O-ring (3) of the new oil filter.
3. Install the new oil filter and tighten to the specified torque.

**TORQUE: 22 N·m (2.2 kgf·m, 16 lbf·ft)**

4. Fill with recommended oil to the upper level mark of the oil level dipstick.
5. Start the engine and warm up for 1 to 2 minutes.

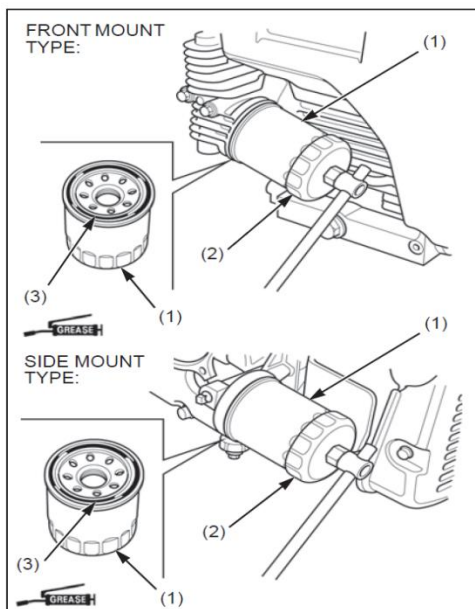

**Figure 13- Oil Changing Process**

6. Check the oil level and if necessary, fill the recommended oil to the upper mark of the oil level dipstick.

### NOTE

Replace engine oil and filter every 500 Hours.

**CAUTION**

This filter canister **ONLY** accepts the Honda Approved Air Filter. Do not use unapproved cross-referenced parts.

**NOTE**

The air filter should be inspected every 1000 hours of operation.

**Replacing the Air Filter**

A dirty air filter will restrict air flow to the carburetor, reducing engine performance. If the engine is operated in dusty areas, clean the air cleaner more often than specified in the MAINTENANCE SCHEDULE section.

**Replacing Air Filter**

1. Remove the air cleaner cover. Remove the foam element from the air cleaner cover. Remove the paper element from the air cleaner case.
2. Check both air cleaner elements for holes or tears and replaced it if damaged.
3. Clean both air cleaner elements if they are to be reused.

**Foam Element:** Clean in warm soapy water, rinse and allow to dry thoroughly, or clean in non-flammable solvent and allow to dry. Do not put oil to the foam element.

**Paper Element:** Tap the element several times on a hard surface to remove dirt or blow with compressed air [not exceeding 30 psi (207kPa, 2.1 kg/cm<sup>2</sup>) through the element from the clean side that faces the engine.

Never try to brush off dirt. Brushing will force dirt into the fibers.

4. Wipe dirt from the inside of the air cleaner case and cover, using a moist rag. Be careful to prevent dirt from entering the air duct that leads to the carburetor.
5. Place the foam element to the air cleaner cover. Reinstall the paper element and the air cleaner cover to the air cleaner case

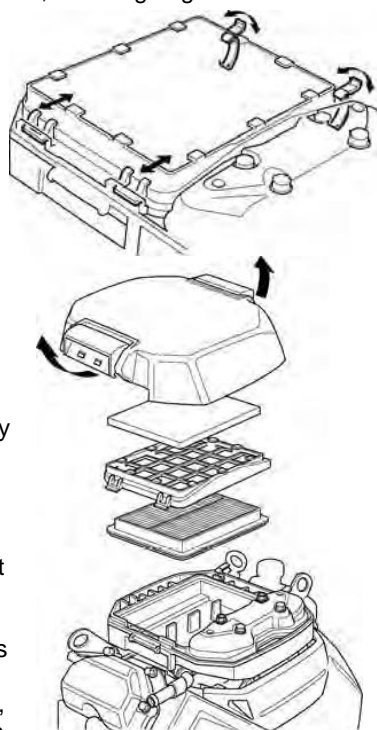

## Serpentine Drive Belt

RigMaster LGN APU's are equipped with a serpentine drive belt that drives the air conditioning compressor and Alternator from the flywheel of the engine.

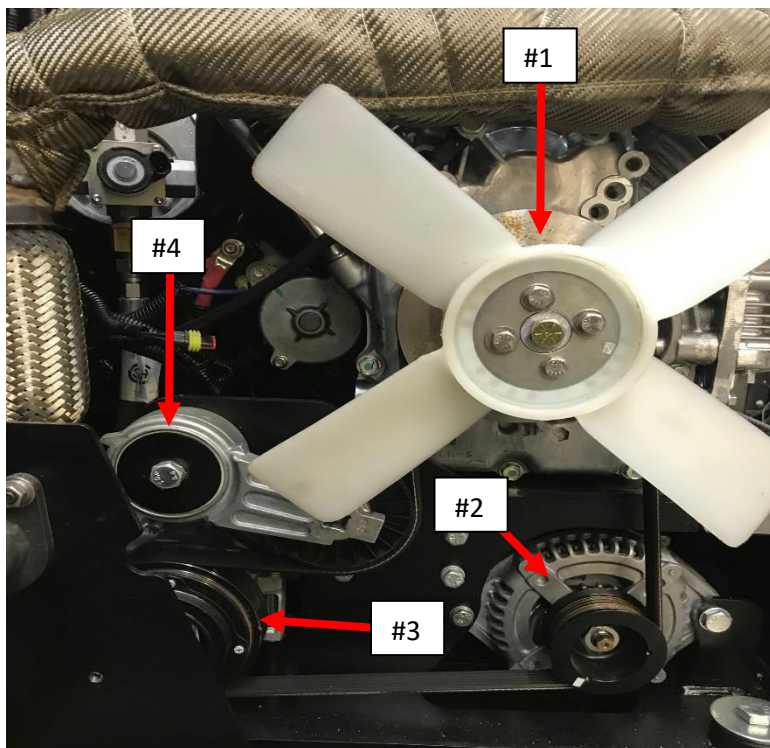

Belt rotation is Counter- clockwise, when viewed from fan side for engine.

Figure 15– Serpentine Compressor Belt

#	COMPONENT	PART #
1	Flywheel Drive Pulley	TBD
2	Alternator	LG7-004
3	Compressor	LG9-004
4	Tensioner	RP8-106

**Procedure to Replace Serpentine Belt****TOOLS REQUIRED**

Adjustable Wrench  
3/8 Ratchet

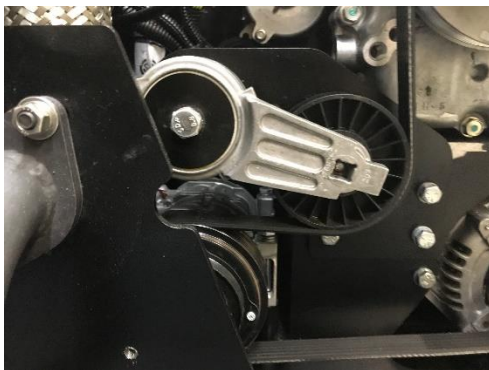

**Figure 16 a- Removing Belt**

1. Remove engine cover.
2. Insert breaker bar or ratchet into serpentine belt auto tensioner as shown in Fig 16a
3. Lift the breaker bar to release tension on serpentine belt.
4. Remove belt from flywheel pulley while holding tensioner.
5. Release tensioner and remove belt.
6. Replace and route drive belt.
7. Rotate the engine to ensure that the belt is properly seated on all pulleys before starting the engine.

**NOTE**

The A/C compressor is in a fixed location so there is no need for adjustment brackets.

## Cleaning Instructions

The RigMaster Auxiliary Power Unit should be periodically inspected and any accumulation of road contaminants (such as paper, plastic, dirt, oil; etc.) must be removed. The main components, as outlined below, must be kept clean and free of contaminants and/or debris.

### Main Unit General Cleaning

1. Wash the exterior of the main unit making sure that all louvered areas are clear (this is especially important so that air may easily enter and exit the APU).
2. Remove the front cover and gently wash the interior of the APU being careful to keep sprayer 2 feet (24 inches) from any component.
3. Before replacing the front cover, you will have to spray all electrical connections & sensors to prevent the connections & sensors from corroding. Make sure the engine compartment is dry first. Using battery sealant, spray the positive & negative post, glow plugs, and run solenoid. (see below for areas to spray with battery sealant).

#### NOTE

The following parts are not shown in the picture, but make sure that the wire to the starter solenoid & the positive post on the alternator & starter is sprayed with battery spray. Apply dielectric grease to the low oil sensor, high temperature sensor & the binary switch. For all other connections, use a silicon-based spray product. **Make sure the boots are installed back on to the sensors.**

## Cleaning the HVAC Filter

**NOTE**

The HVAC filter does not need to be replaced unless it is damaged. The filter should be cleaned every 1000 hours of operation.

**Figure 24 – HVAC Box****Figure 17 – HVAC Heating & Cooling Box****Thumb Nuts**

1. Unscrew the two thumb nuts (see Figure 25) and remove the foam air filter from the HVAC box.
2. Wash the air filter using soapy water or blow clean with compressed air and allow filter to dry completely.
3. Reinsert the air filter and hand tighten the two thumb nuts.

## Troubleshooting

Technical support is available by calling (800) 249-6222 or (416) 201-0040 (Monday to Friday from 8:00 a.m. to 5:00 p.m. Eastern Standard Time)

Technical Support can also be accessed via the internet at [www.rigmasterpower.com](http://www.rigmasterpower.com)  
(click: Customer Support, Support Materials, Technical Support)

## Troubleshooting – Engine

SYMPTOM	PROBABLE CAUSE	REMEDY/COMMENT
<b>Engine does not Crank</b>	<ol style="list-style-type: none"> <li>1. Low battery voltage.</li> <li>2. Battery connections loose.</li> <li>3. Starter relay problem.</li> <li>4. Broken engine ground strap.</li> <li>5. Starter motor faulty.</li> </ol>	<ol style="list-style-type: none"> <li>1. Check batteries.</li> <li>2. Tighten connections.</li> <li>3. Check for power at relay during starting sequence.</li> <li>4. Replace strap.</li> <li>5. Check for power at starter solenoid.</li> </ol>
<b>Engine Cranks but does not Start</b>	<ol style="list-style-type: none"> <li>1. Clogged air filter.</li> <li>2. Clogged fuel filter.</li> <li>3. Run solenoid not operating.</li> <li>4. Lift pump faulty.</li> <li>5. Governor Assembly.</li> </ol>	<ol style="list-style-type: none"> <li>1. Replace air filter.</li> <li>2. Replace fuel filter.</li> <li>3. Check 12V at run solenoid.</li> <li>4. See fuel system section.</li> <li>5. See Honda Service Manual.</li> </ol>
<b>Engine Hard to Start</b>	<ol style="list-style-type: none"> <li>1. Air filter clogged.</li> <li>2. Fuel.</li> <li>3. Glow plugs.</li> <li>4. Injectors clogged.</li> </ol>	<ol style="list-style-type: none"> <li>1. Replace air filter.</li> <li>2. See fuel system section.</li> <li>3. Check for power at the glow plugs.</li> <li>4. Inspect/service fuel injectors.</li> </ol>
<b>Engine Cranks Slowly</b>	<ol style="list-style-type: none"> <li>1. Weak or bad batteries.</li> <li>2. Damaged/corroded battery connections.</li> <li>3. Faulty starter.</li> <li>4. Belt driven component problem.</li> </ol>	<ol style="list-style-type: none"> <li>1. Inspect batteries.</li> <li>2. Replace or clean the battery connections.</li> <li>3. Check starter connections.</li> <li>4. Compressor or other belt driven component seized.</li> </ol>

SYMPTOM	PROBABLE CAUSE	REMEDY/COMMENT
<b>Engine Shuts Down</b>	<ol style="list-style-type: none"> <li>1. Clogged air filter.</li> <li>2. Clogged fuel filter.</li> <li>3. Blown fuses.</li> <li>4. Damaged or loose wiring.</li> </ol>	<ol style="list-style-type: none"> <li>1. Replace air filter.</li> <li>2. Replace fuel filter.</li> <li>3. Replace fuse.</li> <li>4. Inspect condition of wiring and wiring connections.</li> </ol>
<b>Dark Gray/Black Smoke</b>	<ol style="list-style-type: none"> <li>1. Engine over loaded.</li> <li>2. Clogged air filter.</li> </ol>	<ol style="list-style-type: none"> <li>1. Seized belt driven component.</li> <li>2. Check and/or replace air filter.</li> </ol>
<b>Engine Starts and Stalls</b>	<ol style="list-style-type: none"> <li>1. Speed sensor.</li> <li>2. Clogged fuel filter.</li> <li>3. Damaged or loose wiring connections.</li> <li>4. Excessive load on the engine; alternator; or A/C compressor.</li> </ol>	<ol style="list-style-type: none"> <li>1. Check speed sensor resistance and gap.</li> <li>2. Replace fuel filter.</li> <li>3. Inspect wiring connection and connectors.</li> </ol>
<b>White or Blue Smoke</b>	<ol style="list-style-type: none"> <li>1. Engine oil too full.</li> <li>2. Coolant in combustion chamber.</li> </ol>	<ol style="list-style-type: none"> <li>1. Inspect &amp; correct oil level.</li> <li>2. Possible failed head gasket.</li> </ol>
<b>Engine Runs Rough</b>	<ol style="list-style-type: none"> <li>1. Air filter clogged.</li> <li>2. Gas Regulator clogged.</li> <li>3. Fuel leak.</li> <li>4. Engine in poor condition.</li> </ol>	<ol style="list-style-type: none"> <li>1. Check air filter assembly.</li> <li>2. Replace Gas Regulator.</li> <li>3. Inspect all hoses and clamps.</li> <li>4. Replace/rebuild the engine.</li> </ol>
<b>Loss of Engine Oil</b>	<ol style="list-style-type: none"> <li>1. Oil seals leaking.</li> <li>2. Leaking drain plug.</li> <li>3. Pinched or clogged breather tube.</li> <li>4. Engine worn or in poor condition.</li> </ol>	<ol style="list-style-type: none"> <li>1. Replace crankshaft seals.</li> <li>2. Replace oil pan plug gasket.</li> <li>3. Repair or replace breather tube.</li> <li>4. Replace and/or rebuild the engine.</li> </ol>

## Troubleshooting – Charging System

SYMPTOM	PROBABLE CAUSE	REMEDY/COMMENT
<b>Batteries not Charging</b>	<ol style="list-style-type: none"> <li>1. Loose or broken belt.</li> <li>2. Damaged or loose battery connection.</li> <li>3. Poor battery condition.</li> <li>4. Faulty alternator.</li> </ol>	<ol style="list-style-type: none"> <li>1. Tighten or replace belt.</li> <li>2. Inspect and/or replace battery connections.</li> <li>3. Test batteries.</li> <li>4. Check voltage at alternator field coil wire and truck batteries.</li> </ol>
<b>Batteries Overcharging</b>	<ol style="list-style-type: none"> <li>1. Faulty alternator.</li> </ol>	<ol style="list-style-type: none"> <li>1. Check alternator output.</li> </ol>

## Troubleshooting – Fuel System

SYMPTOM	PROBABLE CAUSE	REMEDY/COMMENT
<b>Fuel Odor or Leak</b>	<ol style="list-style-type: none"> <li>1. Loose fuel fittings.</li> <li>2. Damaged fuel line.</li> <li>3. Damaged fuel filter bowl.</li> <li>4. Fuel lift pump leak.</li> </ol>	<ol style="list-style-type: none"> <li>1. Tighten clamps.</li> <li>2. Replace fuel hose.</li> <li>3. Replace fuel filter assembly.</li> <li>4. Replace gas regulator.</li> </ol>
<b>No Start Condition (fuel getting to cylinders)</b>	<ol style="list-style-type: none"> <li>1. Clogged gas regulator.</li> <li>2. Faulty Spark Plug.</li> </ol>	<ol style="list-style-type: none"> <li>1. Replace gas regulator.</li> <li>2. Replace spark plugs.</li> </ol>
<b>Air in Fuel System</b>	<ol style="list-style-type: none"> <li>1. Worn or crack in fuel line.</li> <li>2. Lose hose clamps.</li> <li>3. Faulty gas regulator.</li> <li>4. If pick-up tube was installed in tank, may draw air if fuel too low.</li> </ol>	<ol style="list-style-type: none"> <li>1. Replace fuel lines.</li> <li>2. Tighten clamps.</li> <li>3. Replace gas regulators.</li> <li>4. Add fuel to tank so pick-up tube is submerged.</li> </ol>

## Troubleshooting – Cooling System

SYMPTOM	PROBABLE CAUSE	REMEDY/COMMENT
<b>Engine Overheating</b>	<ol style="list-style-type: none"> <li>1. Engine fan belts loose.</li> <li>2. Radiator fins blocked.</li> <li>3. Electric fan.</li> <li>4. Electrical fan temperature switch.</li> <li>5. Engine overloading.</li> </ol>	<ol style="list-style-type: none"> <li>1. Tighten or replace fan belt.</li> <li>2. Clean radiator fins.</li> <li>3. Replace electric fan.</li> <li>4. Replace switch.</li> <li>5. Seized belt driven component.</li> </ol>
<b>Engine Overcooling</b>	<ol style="list-style-type: none"> <li>1. Check spark plugs.</li> <li>2. Low engine compression.</li> </ol>	<ol style="list-style-type: none"> <li>1. Replace spark plugs.</li> <li>2. Replace engine.</li> </ol>
<b>Coolant Loss</b>	<ol style="list-style-type: none"> <li>1. System over-filled.</li> <li>2. External hose leak.</li> <li>3. Internal hose leak.</li> </ol>	<ol style="list-style-type: none"> <li>1. Check coolant level.</li> <li>2. Check coolant hoses from main unit to the HVAC box.</li> <li>3. Check coolant hoses inside the engine compartment.</li> </ol>

## Troubleshooting – HVAC System

SYMPTOM	PROBABLE CAUSE	REMEDY/COMMENT
<b>Poor Air Flow</b>	<ol style="list-style-type: none"> <li>1. HVAC filter clogged.</li> <li>2. HVAC air intake obstructed.</li> <li>3. Excessive duct hose.</li> <li>4. Poor placement of vent.</li> <li>5. Faulty blower motor.</li> <li>6. Ducted through truck's ventilation system.</li> </ol>	<ol style="list-style-type: none"> <li>1. Clean filter.</li> <li>2. Remove obstruction.</li> <li>3. Reduce the hose length.</li> <li>4. Relocate the vent.</li> <li>5. Replace blower motor.</li> <li>6. See Installation Manual for mounting methods.</li> </ol>

SYMPTOM	PROBABLE CAUSE	REMEDY/COMMENT
<b>Little or No Hot Air</b>	<ol style="list-style-type: none"> <li>1. Insufficient engine load.</li> <li>2. Low electronic coolant control valve faulty.</li> <li>3. Low coolant or air lock.</li> <li>4. Cooling system blocked.</li> </ol>	<ol style="list-style-type: none"> <li>1. Check if main engine block heater is plugged in.</li> <li>2. Check water valve operation.</li> <li>3. Bleed system of air and fill.</li> <li>4. Flush cooling system.</li> <li>5. Faulty engine thermostat.</li> </ol>
<b>Little or No Cold Air</b>	<ol style="list-style-type: none"> <li>1. Cabin Controller not set to A/C mode.</li> <li>2. No Output power to Pin #2 on connector J1.</li> <li>3. A/C system leak.</li> <li>4. Condenser/radiator dirty.</li> <li>5. Compressor not working.</li> <li>6. Evaporator core frozen.</li> <li>7. Electric fan not operating.</li> <li>8. Electronic coolant control valve faulty.</li> </ol>	<ol style="list-style-type: none"> <li>1. Set Controller temperature.</li> <li>2. Check for 12V at A/C clutch control output.</li> <li>3. Check system pressures.</li> <li>4. Clean radiator/condenser.</li> <li>5. Check the compressor and fuse.</li> <li>6. Replace thermostatic switch.</li> <li>7. Check fan relay and fuse.</li> <li>8. Replace electronic coolant control valve.</li> </ol>

## Troubleshooting – Serpentine Drive Belt

SYMPTOM	PROBABLE CAUSE	REMEDY/COMMENT
<b>Belt has Premature Wear</b>	<ol style="list-style-type: none"> <li>1. Use of incorrect belt.</li> <li>2. Damage to pulleys.</li> <li>3. Misalignment of pulleys.</li> </ol>	<ol style="list-style-type: none"> <li>1. Use correct belt.</li> <li>2. Replace damaged pulleys.</li> <li>3. Realign pulleys.</li> </ol>
<b>Belt is Loose and/or comes off repeatedly during Operation</b>	<ol style="list-style-type: none"> <li>1. Use of incorrect belt.</li> <li>2. Damage to pulleys.</li> <li>3. Maladjusted Belt.</li> </ol>	<ol style="list-style-type: none"> <li>1. Use correct belt.</li> <li>2. Replace damaged pulleys.</li> <li>3. Replace belt.</li> </ol>

For additional diagnostic and troubleshooting information, please visit **[www.rigmasterpower.com](http://www.rigmasterpower.com)** and click on the "Customer Support" heading, "Support Materials" menu option.

## **RigMaster Power APU Warranty Policy**

### **The Limited Warranty**

This limited warranty applies to the RigMaster Auxiliary Power Unit (RigMaster APU) which consists of the following components:

1. The generator set.
2. The generator set control panel.
3. The combination heater/air conditioning system.

### **Warranty Coverage**

Rig Master Power International Ltd. warrants that, under normal service and use, the RigMaster APU will be free from defects in material and workmanship for a term of 12 months/2000 hours or a term of 24 months/4000 hours, depending on the term of the warranty coverage purchased, for the APU components listed, excluding the engine (Refer to the engine warranty coverage section of the policy). The RigMaster APU warranty coverage shall begin from the date of installation or from the time the Owner takes possession of the RigMaster APU if the APU is installed with a new vehicle purchase, whichever comes first, and is subject to all terms and conditions, limitations and provisions of the limited warranty. This limited warranty is governed by the laws of the Province of Ontario, Canada, and any claims or disputes arising out of this limited warranty shall be governed by the laws of the Province of Ontario, Canada.

### **Warranty Obligation**

During the warranty period, RigMaster Power will repair or replace, at its option, the RigMaster APU components, which consist of:

1. The electronic controls.
2. The combination heater/air conditioning system components.

Repair or replacement will be completed at an authorized Dealer, upon presentation of proof of purchase and determination by RigMaster Power or its authorized Dealer that a component has failed under normal service and use, at NO CHARGE to the Owner, within the established warranty period of 12 months/2000 hours or 24 months/4000 based on the warranty coverage purchased.

### **Engine Warranty Coverage**

The RigMaster APU comes equipped with a Honda engine. This engine comes with a 24-month warranty from the engine manufacturer which covers all engine components excluding alternator and starter. The alternator and starter are warranted for a period of 12 months/2000 hours by the engine manufacturers.

### **Disclaimer of Other Warranties**

**RIGMASTER POWER, INCLUDING ITS AGENTS AND AUTHORIZED DEALERS, MAKES NO OTHER WARRANTIES AND EXPRESSLY DISCLAIMS ALL OTHER WARRANTIES, EXPRESSED OR IMPLIED, INCLUDING ALL WARRANTIES OF MERCHANTABILITY AND FITNESS FOR A PARTICULAR PURPOSE.** No person, firm or representative is authorized to assume any obligation or make any warranty on behalf of RigMaster Power other than the limited warranty as stated herein.

### Maintenance

The RigMaster Owner's Manual lists all maintenance functions to validate this limited warranty. **PLEASE NOTE THAT FAILED COMPONENTS DUE TO POOR OR IMPROPER MAINTENANCE WILL NOT BE COVERED BY THIS LIMITED WARRANTY.** Where a dispute arises regarding proper maintenance, the manufacturer reserves the right to request proof in the form of receipts for maintenance and any other records of service to establish that proper maintenance has been performed, as per the maintenance schedule and/or Dealer communications.

### Installation

It is the responsibility of the installer and the Owner to ensure that **ALL** RigMaster APU components are in proper working order at the time of installation. The manufacturer is not responsible for failed components that are a result of improper installation. In the event the Owner/Fleet wishes to install the APU themselves, it is the Dealer's responsibility to provide installation instructions to the Owner/Fleet with the sale of the APU. In order to validate your RigMaster warranty, the APU must be inspected and certified by an authorized RigMaster Dealer within 30 days of purchase. The cost of inspecting and certifying any RigMaster APU is at the Owner's expense, and if validated, warranty coverage begins from the date of **PURCHASE** and **NOT** the date of certification.

### Warranty Voided or Terminated

Any modifications to the RigMaster without written authorization from the manufacturer will void this limited warranty. Repair, replacement, or maintenance, using other than approved parts, may be cause to terminate this limited warranty, as will use of starting aids such as ether.

### Exclusions for Limited Warranty

The cost of normal maintenance, such as but not limited to, tune-ups, adjustments, and inspections, tightening of clamps, fasteners, hoses, the replacement of belts, fuel, air and oil filters, unless damaged by cause of a warrantable failure, are excluded from this limited warranty.

### Limitations of Remedies

The remedy of repair or replacement as set forth herein is the exclusive remedy available to the purchaser or user of the RigMaster. RigMaster Power International Ltd. disclaims and shall not be liable or responsible to the Owner or user of the RigMaster APU or any other person for incidental, consequential, direct, indirect, special or general damages of any kind arising out of or in any way related to the use of the RigMaster APU, including but not limited to, towing charges, accident repairs, road calls, traveling expenses, loss of revenue profits, loss of truck use or damage to persons or property. No claim of any kind asserted against RigMaster Power International Ltd., whether asserted under legal theories of negligence, strict liability, warranty, or any other common law or statutory basis, shall be greater in amount than the purchase price of the RigMaster APU with respect to which damages are claimed.

### **Indemnity**

The user and Owner of the RigMaster APU agree to indemnify and hold RigMaster Power International Ltd. harmless from any and all claims, expenses, suits or liability of any nature whatsoever asserted against RigMaster Power International Ltd. arising out of or in any way related to negligence on the part of the user or Owner of the Rig Master APU.

### **Warranty Claims**

Failed or defective parts must be inspected, and their replacement installed by an authorized RigMaster Dealer. The manufacturer reserves the right to inspect failed or defective parts prior to a decision on any claim under this limited warranty. It is the Owner's responsibility to act promptly in submitting any such claim.

### **Transfer of Warranty**

Where the vehicle with the RigMaster APU has been sold by the first Owner to a second Owner and the RigMaster has not been removed, this limited warranty is transferable from the original Owner to a second Owner with whatever portion of the limited warranty that remains from the date of sale. Where the RigMaster APU has been removed and sold by the first Owner to a second Owner, re-installation is to be completed by a RigMaster authorized Dealer to validate the remaining portion of this limited warranty. Where the original Owner transfers the RigMaster APU to a new vehicle, the installation must be completed by an authorized Dealer to validate any remaining portion of this limited warranty.

### **Warranty Policy**

RigMaster Power International Ltd. warrants that under normal service and use, the RigMaster APU will be free from defects in materials and workmanship as stated.

During the warranty period RigMaster Power International Ltd. will provide the

exclusive remedy of ensuring the repair or replacement of those **parts** which are demonstrated to be defective in material or workmanship. RigMaster Power International Ltd. will not, under any terms, replace the entire APU as a means of repair.

The purpose of this warranty is to provide the Owner of the RigMaster APU with **free** repair or replacement of defective parts in a manner outlined in the following policy. This remedy does not apply to normal wear and tear of service parts, improper installation, deterioration, modification or economic loss.

### Warranty Qualification

All RigMaster Power APUs are eligible for warranty repair for a period of 12 months /2000 hours or 24 months/4000 hours from the "in-service date" as stated on the warranty registration form for all RigMaster APU components excluding the engine. RigMaster Power International Ltd. maintains a complete list of registered RigMaster Owners. Dealers are invited to contact RigMaster Power International Ltd. to obtain "in-service date", where available.

### Honda Engine

Honda engines are warranted by the engine manufacturer for a period of 24 months. for all engine components excluding starter and alternator. The starter and alternator are warranted for 12 months/2000 hrs. Honda engine warranty repairs must be performed by a registered Honda Dealer.

### Warranty Registration

It is the responsibility of the installing Dealer to register the RigMaster APU installed by the Dealer's trained technicians. The installing Dealer must register the in-service date of the warranty from the time the Owner takes possession of the Rig Master APU. In the event the Owner/Fleet have installed the RigMaster APU themselves, the APU must be inspected within 30 days of purchase to validate the warranty. **THE IN-SERVICE DATE BEGINS FROM THE DATE OF PURCHASE AND NOT FROM THE DATE OF CERTIFICATION.**

The Dealer must fill out the warranty check list and fax the check list completed with all of the new Owner's information to 416-293-5104 along with a copy of the original purchase invoice of the APU from RigMaster to validate the warranty period purchased with the APU. The Dealer can also have the option to fill out the online form instead and attach a scanned copy of the purchase invoice from RigMaster to validate the warranty purchased with the APU.

It is the responsibility of the authorized Dealer to inspect and certify that any RigMaster APU has been installed correctly. Costs of certification as well as the cost of any repairs to the APU for certification purposes are the responsibility of the Owner. Failure to properly inspect the APU for certification, and any

damages resulting from improper installation, shall render the warranty void. The installing Dealer is responsible for all repairs resulting from improper installation.

It is the Dealer's responsibility to check the warranty registration of any RigMaster APU prior to performing any warranty repairs. Any warranty claims filed for RigMaster APU's out of warranty shall be rejected by Rig Master Power International Ltd.

### **When Failures Occur due to Improper Installation**

When a RigMaster Dealer determines a failure to have occurred due to an improper installation by their installing technician, it is the Dealer's responsibility to repair the RigMaster APU and correct the installation error at no cost to the Owner. At no time shall RigMaster Power International Ltd. warrant any repairs to the RigMaster APU due to improper installation by the installing Dealer.

When a RigMaster Dealer determines a failure to have occurred due to an improper installation from another installing Dealer, it is the Dealer's responsibility to offer the Owner of the RigMaster APU one of two choices:

1. Have the Owner return to the installing Dealer to have the APU repaired by the installing Dealer.
2. Where the Owner cannot or is unwilling to return to the installing Dealer, perform the repairs at the Owner's expense. It would then be the Owner's responsibility to obtain a refund for work performed from the installing Dealer.

If the Dealer is in doubt as to whether the repair is warrantable or not, it is the Dealer's responsibility to contact RigMaster Power International Ltd. RigMaster Power International Ltd. reserves the right to, and final determination of, whether a repair can be claimed as warranty.

### **Use of Aftermarket Components for Warranty Repairs**

At no time shall a RigMaster Dealer use aftermarket parts for warrantable repairs on a Rig Master APU. The use of aftermarket components for warranty repairs is strictly prohibited by RigMaster Power International Ltd. At no time shall a Dealer manufacture their own parts, including but not limited to, air conditioning hoses, brackets and fittings.

**Transfer of Warranty**

It is the Dealer's responsibility to notify RigMaster Power International Ltd. of a change of ownership when a RigMaster APU has been sold by the first Owner to a second Owner. The Dealer must inform RigMaster Power by means of a written notice with both original Owner's information and new Owner's information so all records can be updated for warranty purposes. When the APU has been removed and sold to a new Owner with remaining warranty, the Dealer must transfer and inspect the APU installation and notify RigMaster Power International Ltd. in writing of the transfer of warranty.

**Customer Assistance Procedure**

To obtain warranty repairs you must request the needed repairs within the warranty period from an authorized RigMaster Dealer.

A reasonable time must be allowed to perform the warranty repair after taking the unit to an authorized Dealer location. Repairs will be performed during normal business hours.

To ensure your complete satisfaction the following procedures must be followed in the event you have a problem:

1. Contact the nearest (most convenient) RigMaster Dealer to schedule a warranty service appointment. Prior to contact have the following information available:
  - i. Unit serial number
  - ii. Hour meter reading
  - iii. In service (Purchase) date
  - iv. Nature of problem.
2. Deliver unit to Dealer for service. Upon completion of repairs review and sign the Dealer work order, keeping a copy for reference.
3. Frequently, customer concerns are a result of a breakdown in communications and can be quickly resolved at the Dealer level.

If you are still not satisfied, present the entire matter in writing to:

RigMaster Warranty Administration  
1320 Ellesmere Road, Unit #1  
Toronto, Ontario, Canada  
M1P 2X9

Fax: (416) 293-5104

or Email: [rigmastertechsupport@rigmasterpower.com](mailto:rigmastertechsupport@rigmasterpower.com)











**RigMaster Power  
International Ltd.**

1320 Ellesmere Road, Unit #1  
Toronto, ON, Canada M1P 2X9

Tel: 1-416-201-0040

**Toll Free: 1-800-249-6222**

Fax: 1-416-293-5104

[www.rigmasterpower.com](http://www.rigmasterpower.com)

---